

# GearKlamp

Works "big" in a small space



Simply better.



BESSEY is introducing a first of its kind in the world with the GearKlamp GK: The clamp that conveniently masters clamping applications in a perfect way – even in the tightest spaces. For example, the compact BESSEY GearKlamp GK can be skill used even in places that were previously difficult or impossible for clamping tools to access.

## Unique compact design

The GearKlamp is extremely flexible and can even be used in the tightest of spatial conditions:

- due to the patented mechanism that separates the handle from the spindle and positions it around the rail
- due to the crossed v-grooves on the upper section for securely holding round, pointed and angular components



## Ergonomic use

The clamp contains all kinds of clamping technology and guarantees the user greater comfort:

- due to the high-quality two-component plastic handle for safe handling
- due to the quick-release shift button for quickly adjusting the sliding bar
- due to the swivelling pressure plate for exact alignment of the workpiece

## Robust technology

Meeting the BESSEY quality promise was a focus in development, and so the transmission clamp is also a winning choice in terms of durability:

- due to the use of high-quality materials, such as fibreglass-reinforced polyamide for the top and bottom, as well as hardened, tempered and burnished steel for the profiled rails
- due to the sliding bar's plastic housing, the driving mechanism is protected from dust and splintering



# GearKlamp

Works "big" in a small space



Simply better.



**Clamping in a narrow section** can cause problems when using classic screw clamps and lever clamps as the handle prevents the clamp from being placed correctly.



**The risk of damage to the workpiece and injury** increases in confined working areas when clamping tools with protruding components are used.



**The clamping in front of a closed surface** is not possible due to the positioning of the handle with classic screw clamps and lever clamps as the handle cannot be actuated.

**The new GearKlamp GK from BESSEY makes it conveniently possible – without additional aids, with enhanced ergonomics, with reduced risk of damage or injury**

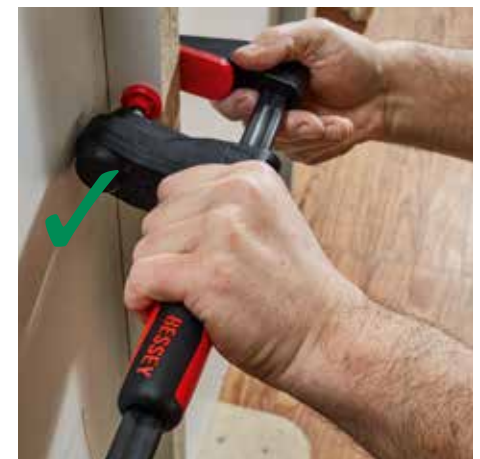

## GearKlamp GK

Order-No.	Opening mm	Throat depth mm	Rail mm	kg	qty.	V3
GK15	150	60	19 x 6	0.62	6	
GK30	300	60	19 x 6	0.73	6	
GK45	450	60	19 x 6	0.84	6	
GK60	600	60	19 x 6	0.94	6	

- High-quality two-component plastic handle positioned around the rail, so clamp can be used in tight spaces
- Clamping force up to 2,000 N
- Easy-to-move trapezoidal thread spindle with swivelling pressure plate
- Quick-release shift button to quickly adjust sliding bar

For further information  
[www.bessey.de](http://www.bessey.de)



BESSEY Tool GmbH & Co. KG ■ Mühlwiesenstraße 40  
74321 Bietigheim-Bissingen, Germany  
Fon +49 7142 401-0 ■ Fax +49 7142 401-452  
E-Mail: [tool-info@bessey.de](mailto:tool-info@bessey.de) ■ [www.bessey.de](http://www.bessey.de)

Your dealer: